



JTGK-700S Graphite High Speed CNC Machine

Product descriptions and features

Features

- Box type structure design and the unique damping characteristic have the machine more excellent dynamic machining performance.
- The axis movement system adopts special protective measures to increase the life of the moving parts.
- Multi-function optional, suitable for different demands of processing .
- The machine tool has a high moving speed, supports fast feed cutting of graphite, and can be matched with automation to improve output efficiency.

For Material

Graphite materials, ceramic green embryos, calcium silicate

Applied Range

High-end graphite electrode and parts processing



KEJIE website



KEJIE wechat

Parameters

Item	Parameter
X/Y/Z travel	700/500/300 mm
Work table dimension	700×500 mm
Max load of worktable	300kg
Spindle power/Max spindle speed	7.2kw/24000rpm 7.8kw/26000rpm
Spindle interface/taper	HSK-E40 BBT30
Rapid traverse rate	30m/min
Cutting feed rate	20m/min
Positioning accuracy	0.008mm/300mm
Repeatability	0.005mm
Machine net weight	5500kg
Machine net dimension	2100×2200×2400mm
Power supply	3-PH AC380V ±5% (50Hz)

Standard Accessories

- High speed CNC controller
- High speed spindle
- AC servo motor
- Precision ball screw and guide rail
- Automatic tool magazine
- Spindle cooling system

Optional Accessories

- 26000rpm HSK-E40 Spindle
- Air dryer
- Laser tool setter
- Probe
- Industrial dust collector
- Fully closed loop control encoder

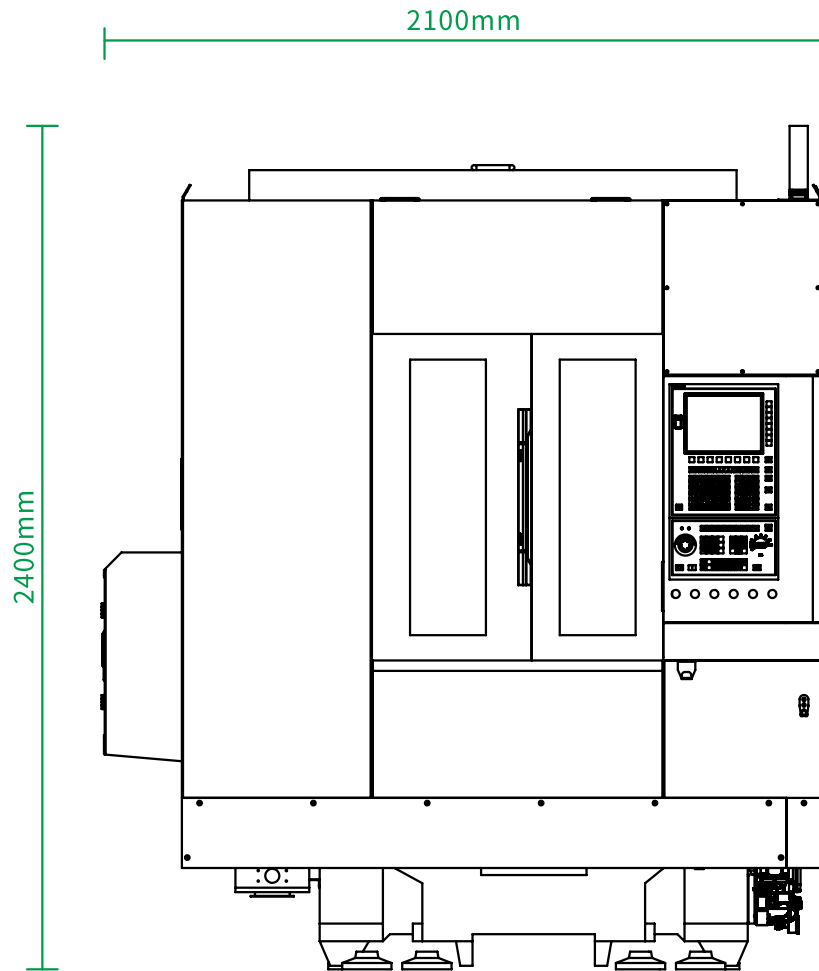

Front

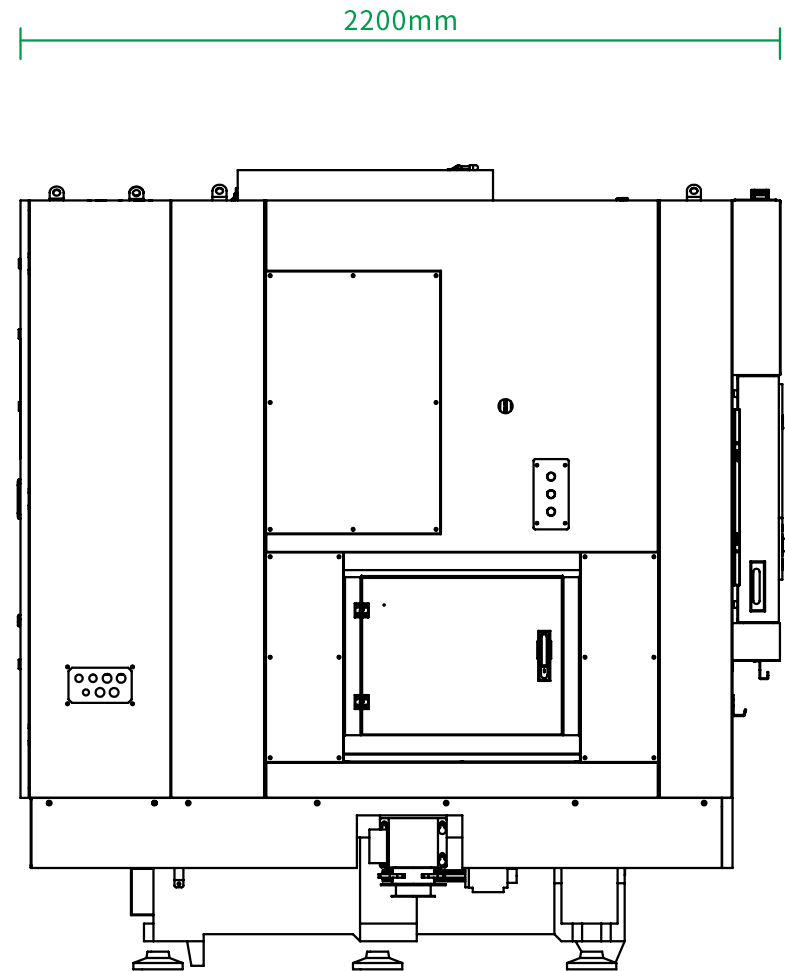

Left