

## JTVC-855P3 Vertical Machining Center

### Product descriptions and features

#### ■ Features

- Years of machine design experience and finite element FEM analysis, exclusive structure design, effectively ensures the machine entire dynamic performance.
- 3 axes adopt linear guide design, low friction, low noise, ensures machine flexibility and stability. This makes the machine keeps accurate machining during faster moving.
- Arm type tool magazine capacity is 24 tools, stable and reliable, it is the necessity of product machining.
- Adopt BT40 high-rigidity tool connector, equip with powerful motor, cutting performance is better.
- Excellent human-machine interaction design, the entire machine is fully sealing protection, convenient for operation.

#### ■ For Material

copper, aluminum, casting iron, steel, stainless steel, etc

#### ■ Applied Range

component mass production in the industries of automotive accessories, aviation and aerospace, 3C products, industrial automation, communication, etc



KEJIE website



KEJIE wechat

## Parameters

Item	Parameter
X/Y/Z travel	800/500/550mm
Work table dimension	1000×500mm
Max load of worktable	800kg
Spindle power/Max spindle speed	15kW/12000rpm
Spindle interface/taper	BBT40
Rapid traverse rate	48m/min
Cutting feed rate	30m/min
Positioning accuracy	0.008mm/300mm
Repeatability	0.005mm
Machine net weight	4500kg
Machine net dimension	2580×2210×2750mm
Power supply	3-PH AC380V ±5% (50Hz)

## Standard Configuration

- High speed CNC controller
- Precision ball screw and guide rail
- AC servo motor
- High speed spindle
- Automatic tool magazine
- Spindle cooling system
- Lubrication system
- Automatic tool setter
- Automatic chip removal device

## Optional Accessories

- High speed CNC controller (JIATIE JT810)
- 4-axis rotary table
- Oil mist collector
- Voltage stabilizer
- Internal chip conveyor
- Chain-plate type chips extractor

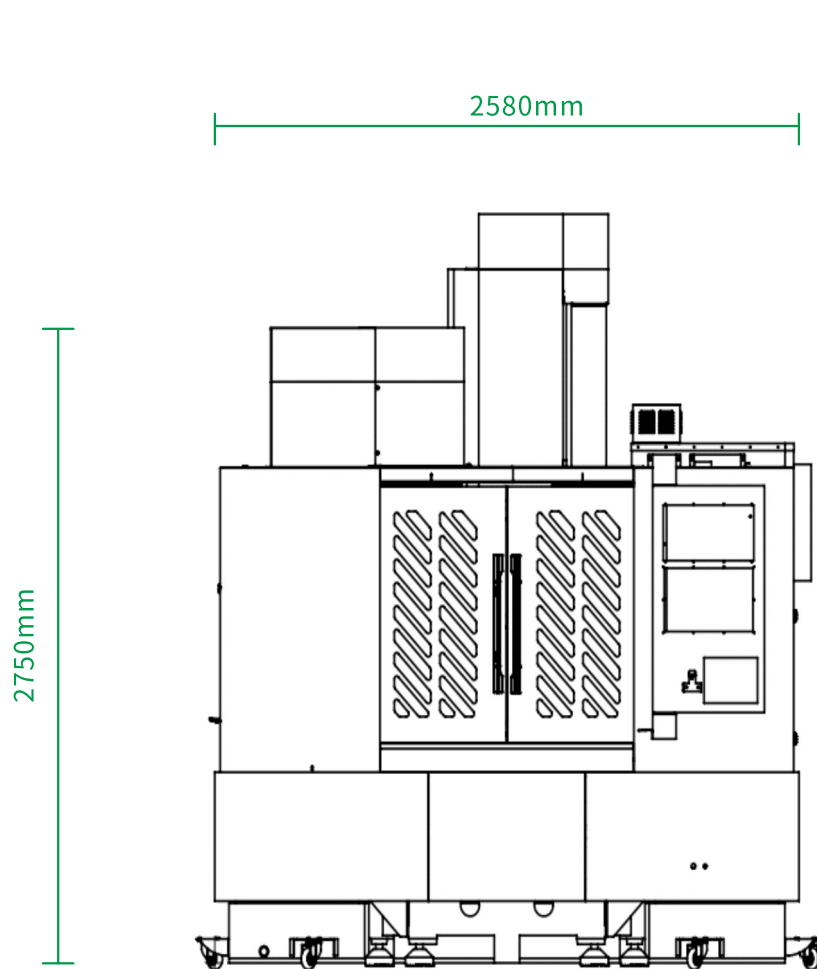

Front

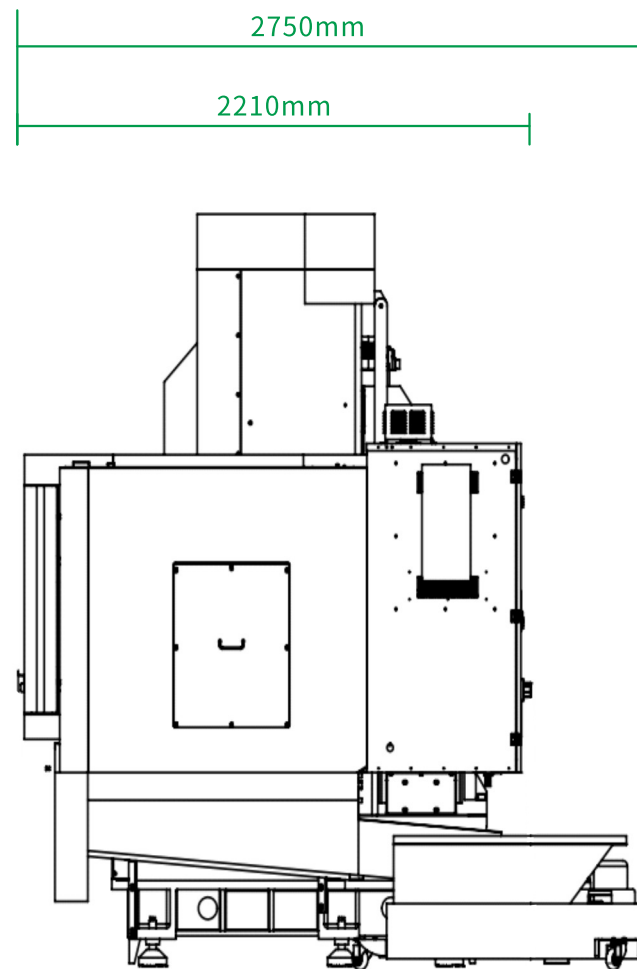

Left