



## JTgk-600 mi CNC Grinding Center

### Product descriptions and features

#### ■ Features

- Closed loop control mode, suitable for any Mini LED board, even Micro LED board cutting.
- Automatic loading and unloading doors are reserved for realize automation.
- CNC system reserved MES system data port, the communication protocol is widely compatible
- The inside of the machine tool adopts stainless steel material to prevent rust in the pure water processing environment effectively
- High-precision CCD automatic dynamic correction system Can recognize various Mark marks
- In-machine measurement system performs testing after processing to ensure high yield.
- Laser tool setting instrument, detect the tool diameter and dynamic runout automatically.

#### ■ For Material

MiniLED

#### ■ Applied Range

semi-conductor



KEJIE website



KEJIE wechat

## Parameters

Item	Parameter
X/Y/Z travel	500/400/200mm
Work table dimension	530×430mm
Max load of worktable	150kg
Spindle power/Max spindle speed	5.5kW/32000rpm
Spindle interface/taper	HSK E32
Rapid traverse rate	15m/min
Cutting feed rate	10m/min
Positioning accuracy	0.003mm/300mm
Repeatability	0.002mm
Machine net weight	3000kg
Machine net dimension	1550×2000×2210mm
Power supply	3-PH AC380V ±5% (50Hz)

## Standard Accessories

- High speed CNC controller
- High speed spindle
- Precision ball screw and guide rail
- AC servo motor
- Wireless probe
- Laser tool setter
- Spindle cooling system
- Fully closed loop control encoder

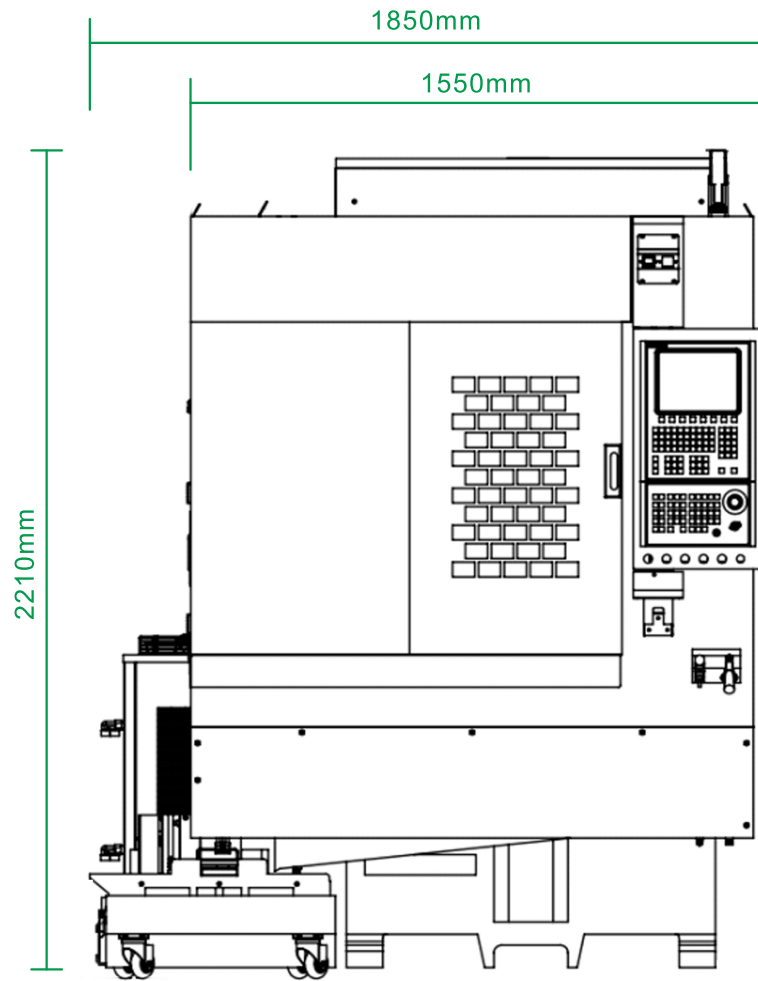

Front

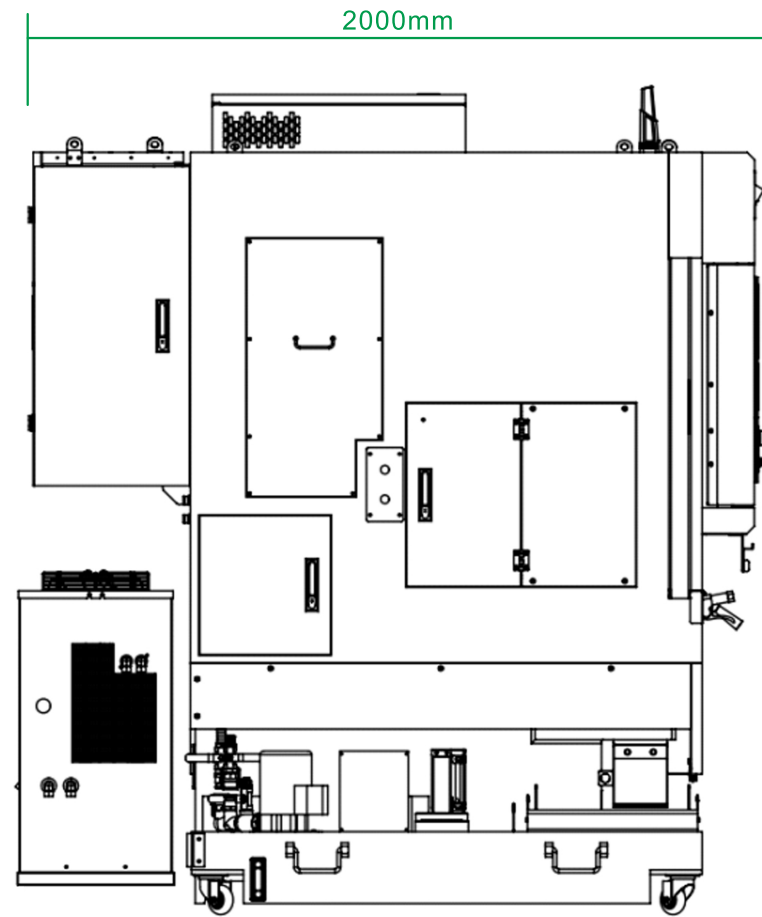

Left