

JTFZ-800 Multiple-Station Customized Machine

Product descriptions and features

■ Features

- The machine has four spindles, each spindles can be controlled independently.
- High-accuracy, high-speed and high-efficiency machining
- Excellent human-machine interaction interface, easy to operation
- Natural granite machine bed structure has the machine in good accuracy retention and corrosion resistance.

■ For Material

glass, composite material, acrylic, stainless steel, aluminum, etc

■ Applied Range

machining of edge grinding, hole making, pocket making, chamfering, drilling, etc in the industries of phone, table computer, intelligent wearing, intelligent house hold appliance and photo electricity, etc



KEJIE website



KEJIE wechat

Parameters

Item	Parameter
X/Y/Z travel	200/300/120mm
Work table dimension	800 x 300mm
Max load of worktable	100kg
Spindle power/Max spindle speed	4.5kW*4/40000rpm
Spindle interface/taper	ISO 20
Rapid traverse rate	15m/min
Cutting feed rate	10m/min
Positioning accuracy	0.008mm/300mm
Repeatability	0.005mm
Machine net weight	4000kg
Machine net dimension	1860x1780x2350 mm
Power supply	3-PH AC380V ±5% (50Hz)

Standard Configuration

- High speed CNC controller
- High speed spindle
- AC servo motor
- Precision ball screw and guide rail
- The 4th axis
- Automatic tool setter
- Tool magazine

Optional Accessories

- Voltage stabilizer
- Oil mist collector

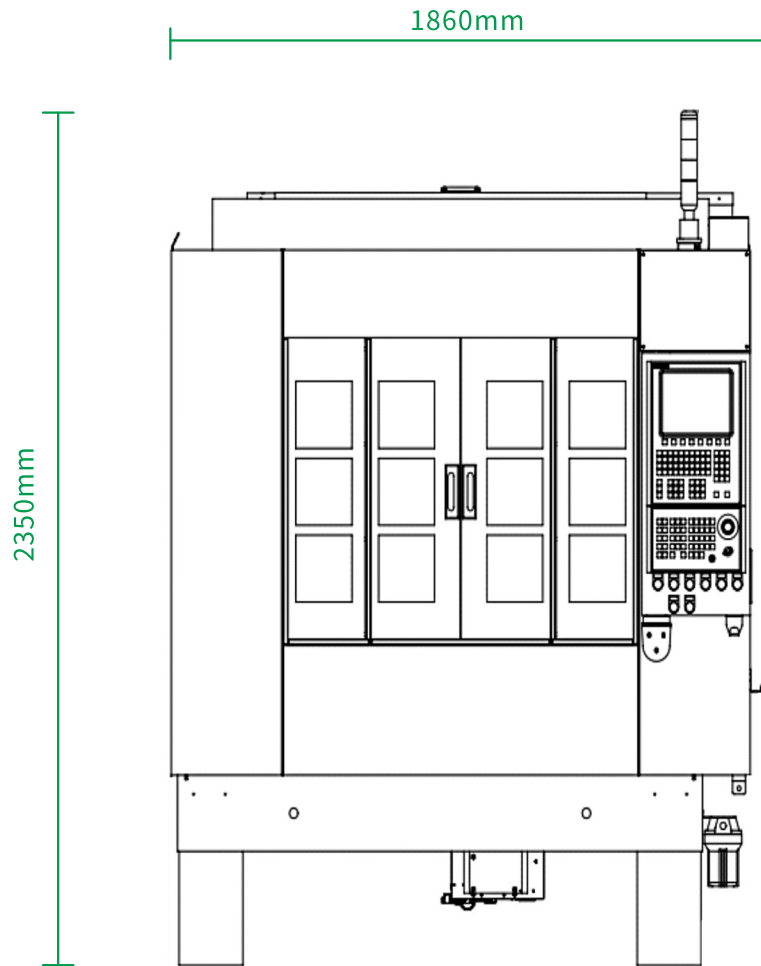

Front

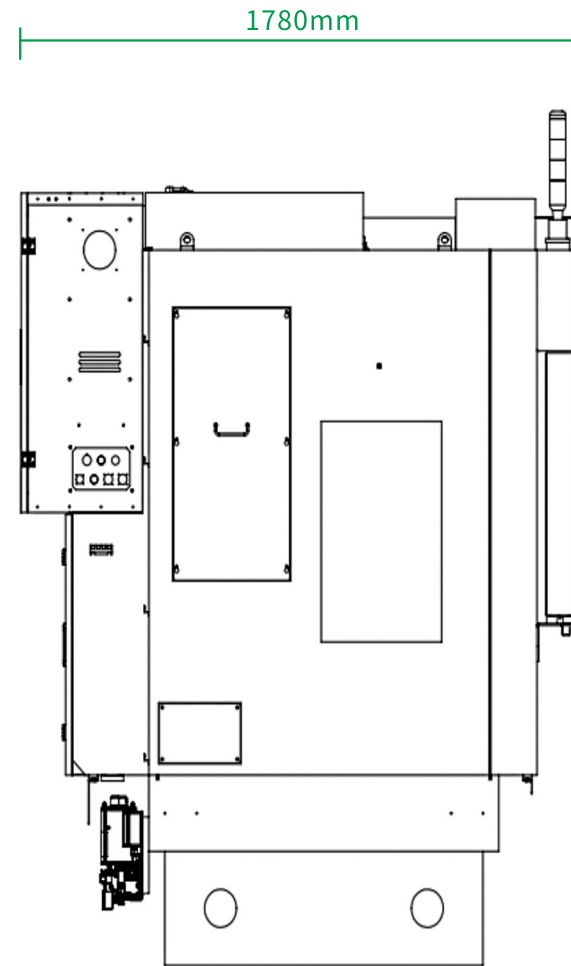

Left