

JTDY-700 Multiple-Station Customized Machine

Product descriptions and features

■ Features

- Natural marble machine bed structure makes the machine good accuracy and have good corrosion proof retention.
- It can realize programming on NC system or on a computer.
- Precise components all have a good anti-dust protection.
- Automatic tool changer lower labor cost.
- Full sealing and all-in-one cabinet structure keeps the machining environment cleaner and covers less foot area.

■ For Material

glass, composite material, acrylic, stainless steel, aluminum, etc

■ Applied Range

machining of edge grinding, hole making, pocket making, chamfering, drilling, etc in the industries of phone, table computer, intelligent wearing, intelligent house hold appliance and photo electricity, etc



KEJIE website



KEJIE wechat

Parameters

Item	Parameter
X/Y/Z travel	350/500/150mm
Work table dimension	350 x 500mm
Max load of worktable	100kg
Spindle power/Max spindle speed	3.2kW/40000rpm
Spindle interface/taper	ISO 20
Rapid traverse rate	15m/min
Cutting feed rate	10m/min
Positioning accuracy	0.008mm/300mm
Repeatability	0.005mm
Machine net weight	4000kg
Machine net dimension	2000x1910x2510 mm
Power supply	3-PH AC380V ±5% (50Hz)

Standard Configuration

- High speed CNC controller
- High speed spindle
- AC servo motor
- Automatic tool setter
- Hand Wheel
- Spindle cooling system

Optional Accessories

- Voltage stabilizer
- Oil mist collector

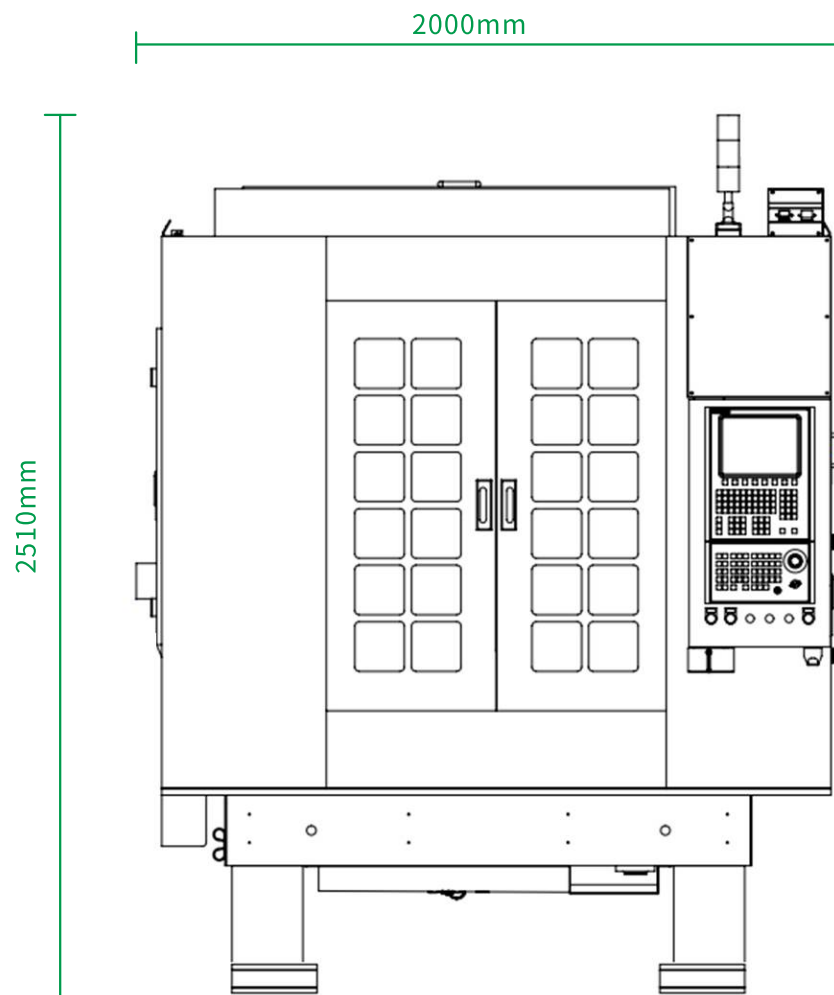

Front

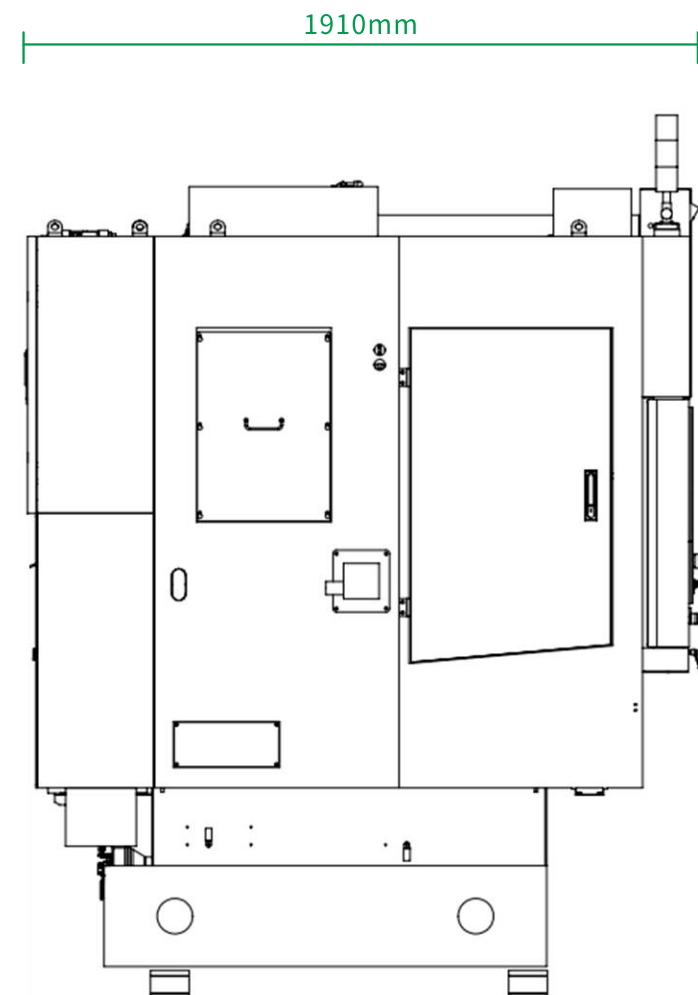

Left