

## JTMA-300

# 5-Axis High-Speed Machine

### Product descriptions and features

#### ■ Features

- Fully closed loop control technology makes machine machining more accurate and reliable.
- High-accuracy, high-speed and high-efficiency machining
- Excellent human-machine interaction design ensures the operational comfort and convenience for operator.
- Gantry structure makes machine dynamic property and precision retention better.
- Equip with DD direct drive 5-axis rotary tables.
- The moving components are completely isolated from the machining area that is easy for machine cleaning
- A large torque or high-speed spindle is optional for meeting machining needs of different industries

#### ■ For Material

copper, aluminum, steel, stainless steel, titanium, quenched material, high polymer material, etc

#### ■ Applied Range

accurate component parts of 5-axis simultaneous machining demand for aviation and aerospace, electric car, medical instrument, etc



## Parameters

Item	Parameter
X/Y/Z travel	600/350/300mm
A/C axis tilt angle	-110°~90°/360°
Work table dimension	φ300mm
Max load of worktable	100kg
Spindle power/Max spindle speed	7.8kW/26000rpm
Spindle interface/taper	HSK E40
Rapid traverse rate	24m/min
Cutting feed rate	10m/min
A/C axis max. speed	50rpm/100rpm
Positioning accuracy	0.003mm/300mm
Repeatability	0.002mm
Machine net weight	7000kg
Machine net dimension	1990×2250×2530mm
Power supply	3-PH AC380V ±10% (50Hz)

## Standard Configuration

- High speed CNC controller
- High speed spindle
- AC servo motor
- Hand Wheel
- Spindle cooling system

## Optional Accessories

- NC system (Siemens ONE)
- Voltage stabilizer
- Oil mist collector
- Automatic probe

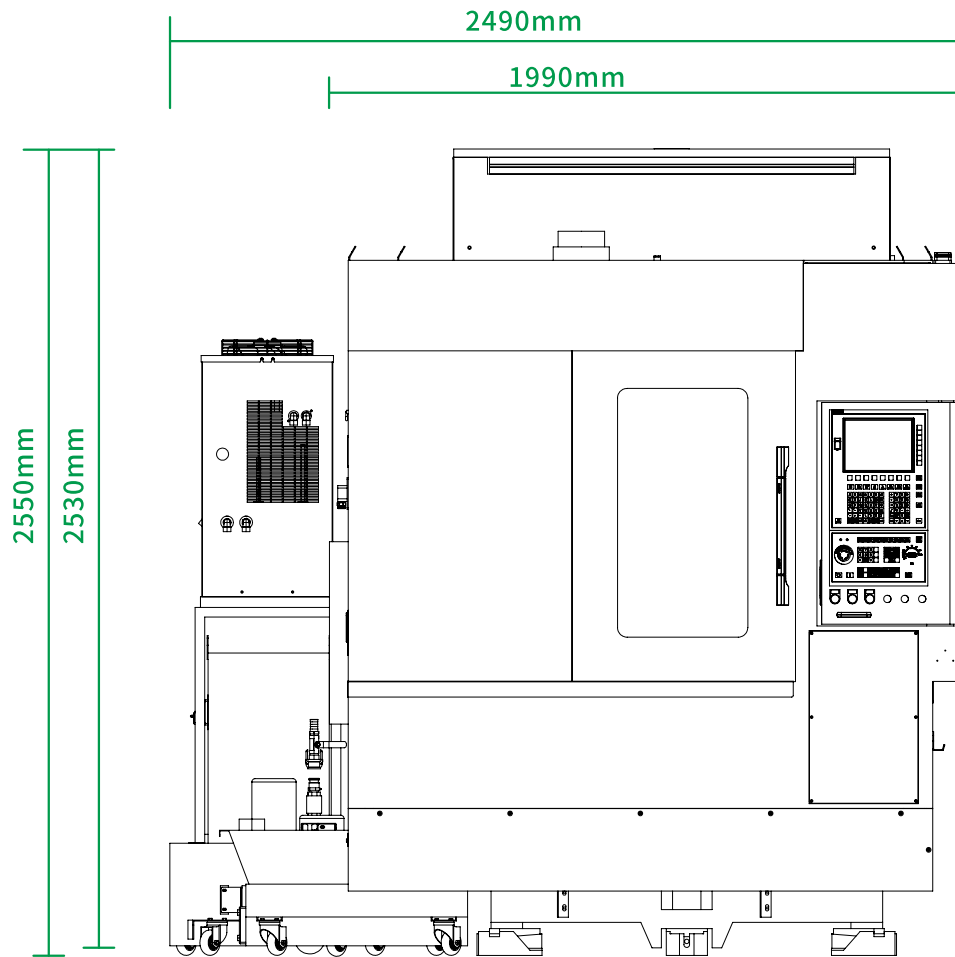

Front

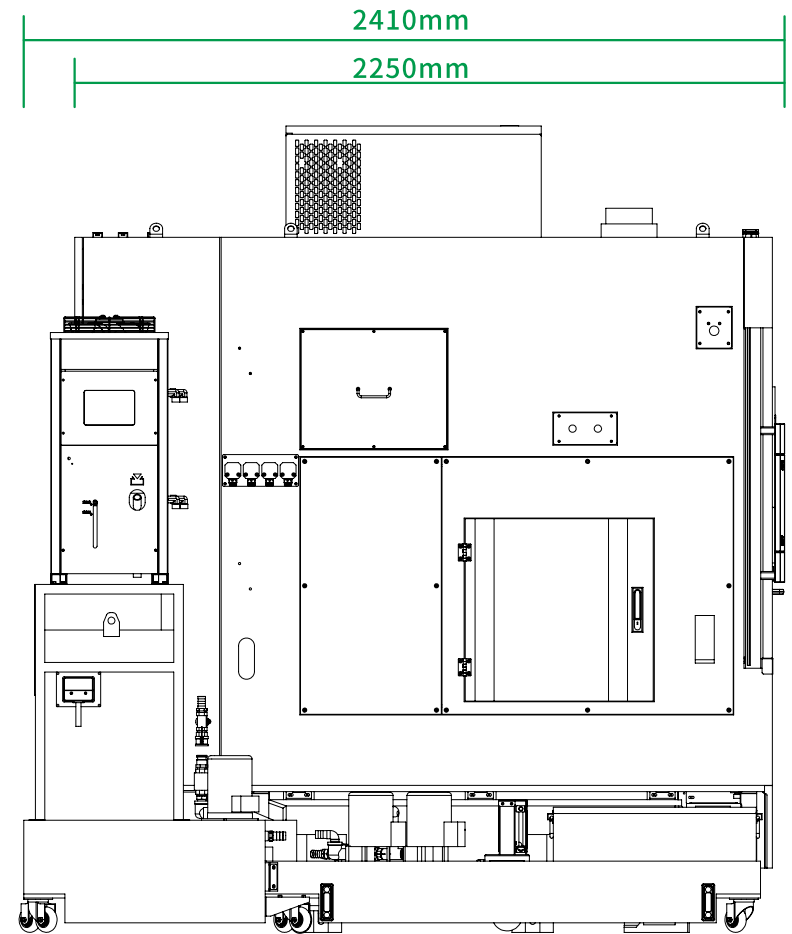

Left