



## JTMA-200 5-Axis High-Speed Machine

### Product descriptions and features

#### ■ Features

- Gantry structure makes machine dynamic property and precision retention better.
- Equip with DD direct drive 5-axis rotary tables.
- The moving components are completely isolated from the machining area that is easy for machine cleaning.
- A large torque or high-speed spindle is optional for meeting machining needs of different industries .

#### ■ For Material

copper, aluminum, steel, stainless steel, titanium, quenched material, high polymer material, etc

#### ■ Applied Range

accurate component parts of 5-axis simultaneous machining demand for aviation and aerospace, electric car, medical instrument, etc



KEJIE website



KEJIE wechat

## Parameters

| Item                            | Parameter               |
|---------------------------------|-------------------------|
| X/Y/Z travel                    | 550/240/250(mm)         |
| B/C axis tilt angle             | ±110°/360°              |
| Work table dimension            | Φ160mm                  |
| Max load of worktable           | 30kg                    |
| Spindle power/Max spindle speed | 5.5kW/32000rpm          |
| Spindle interface/taper         | HSK E32                 |
| Rapid traverse rate             | 15m/min                 |
| Cutting feed rate               | 10m/min                 |
| A/C axis max. speed             | 100rpm/150rpm           |
| Positioning accuracy            | 0.003mm/300mm           |
| Repeatability                   | 0.002mm                 |
| Machine net weight              | 3000kg                  |
| Machine net dimension           | 1650 x 1850 x 2150mm    |
| Power supply                    | 3-PH AC380V ±10% (50Hz) |

## Standard Configuration

- JIATIE high speed CNC controller
- High speed spindle
- AC servo motor
- Precision ball screw and guide rail
- 5-axis rotary table
- Automatic tool magazine
- Hand Wheel
- Spindle cooling system

## Optional Accessories

- NC system (Siemens ONE)
- Voltage stabilizer
- Oil mist collector
- Automatic probe

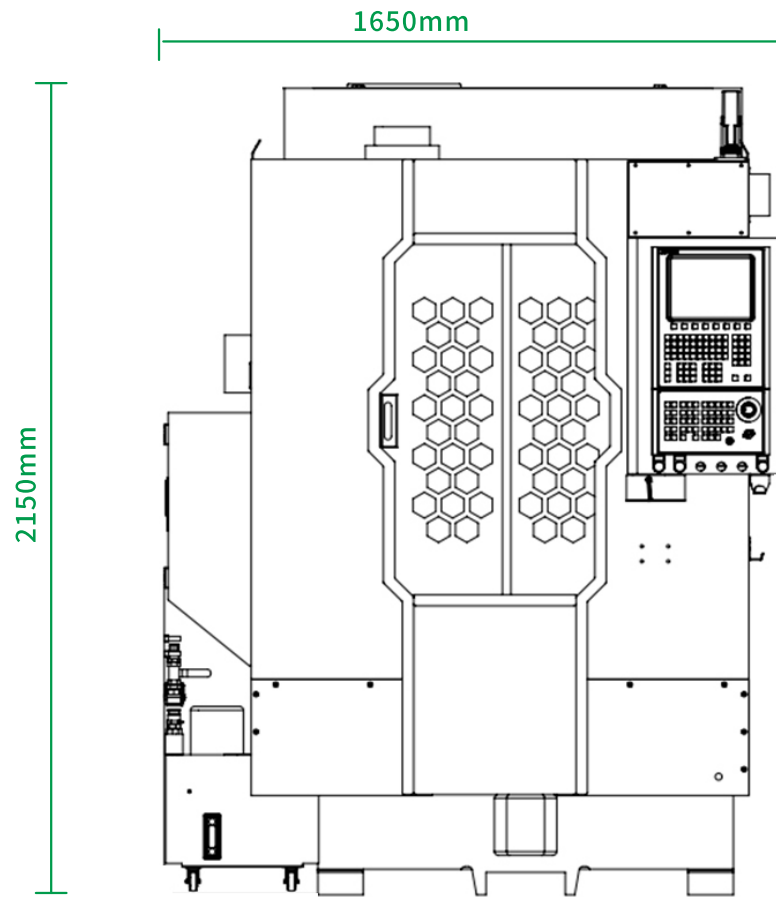

Front

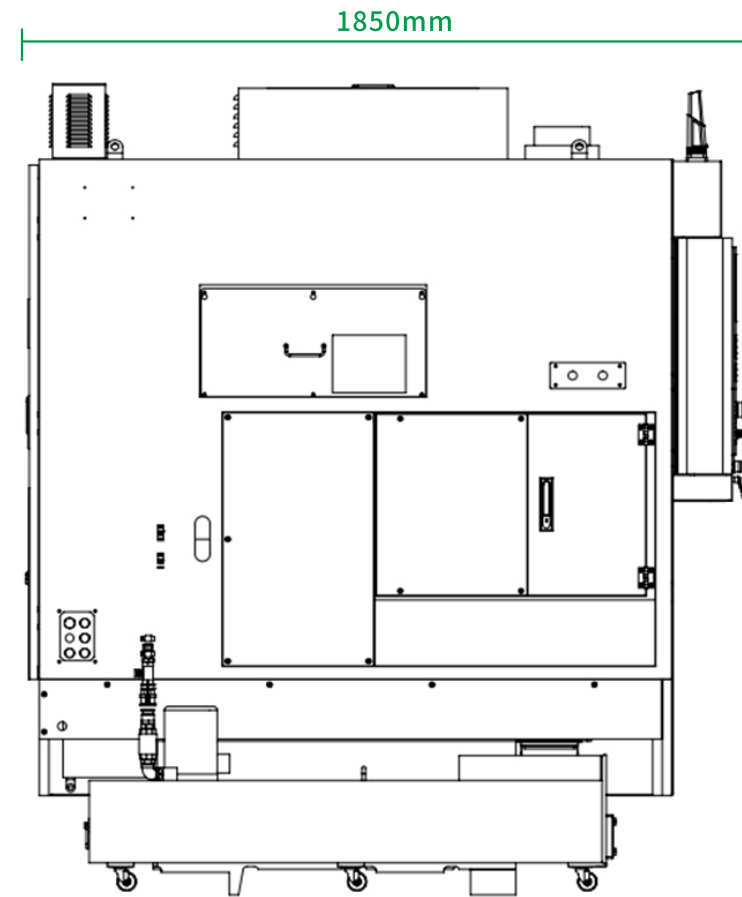

Left